

Part number:

WD-L series

WD-L series overview

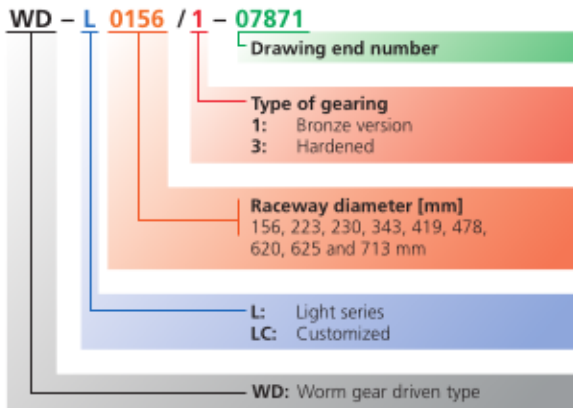

Maximum torque $M_{d \max}$ of the individual sizes

CAUTION: The duty per minute is limited.
Please always observe the explanations in the Technical Information section (from page 60).

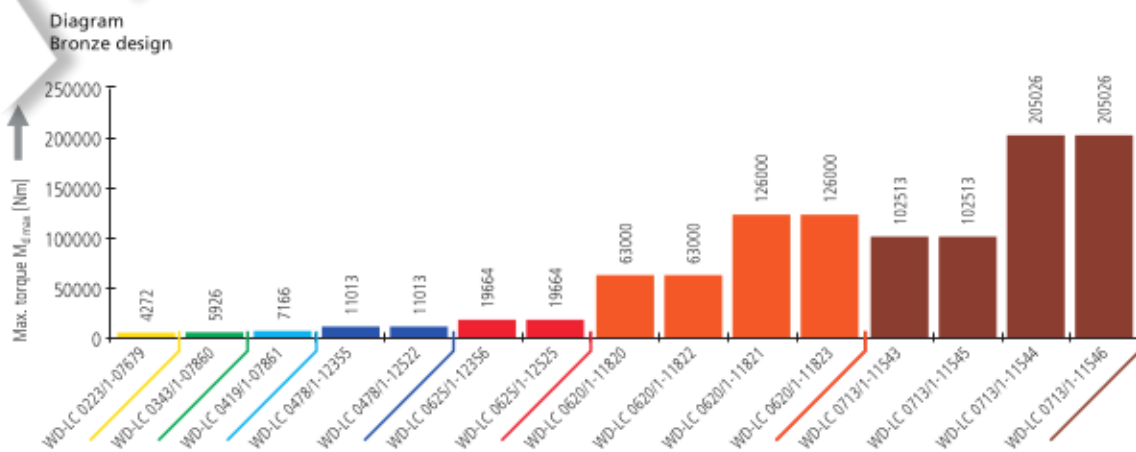
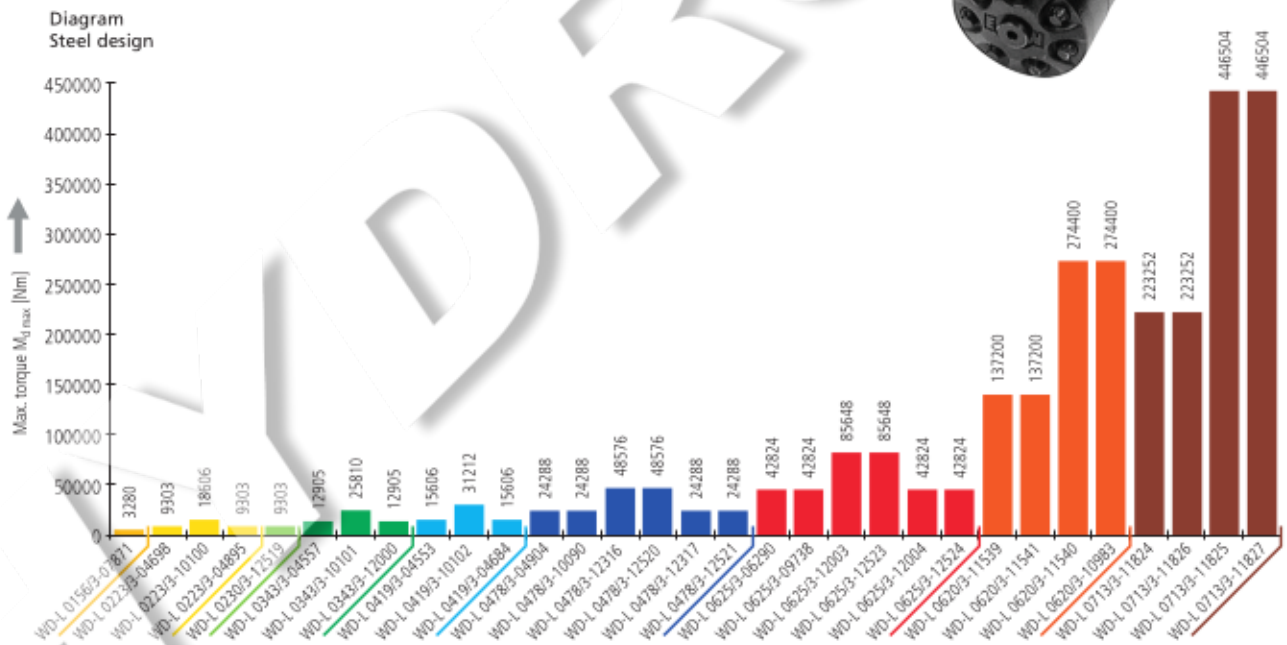

WD-L series overview

Limiting load diagrams of the individual sizes for compressive loads

Please always observe the explanations in the Technical Information section (from page 60).

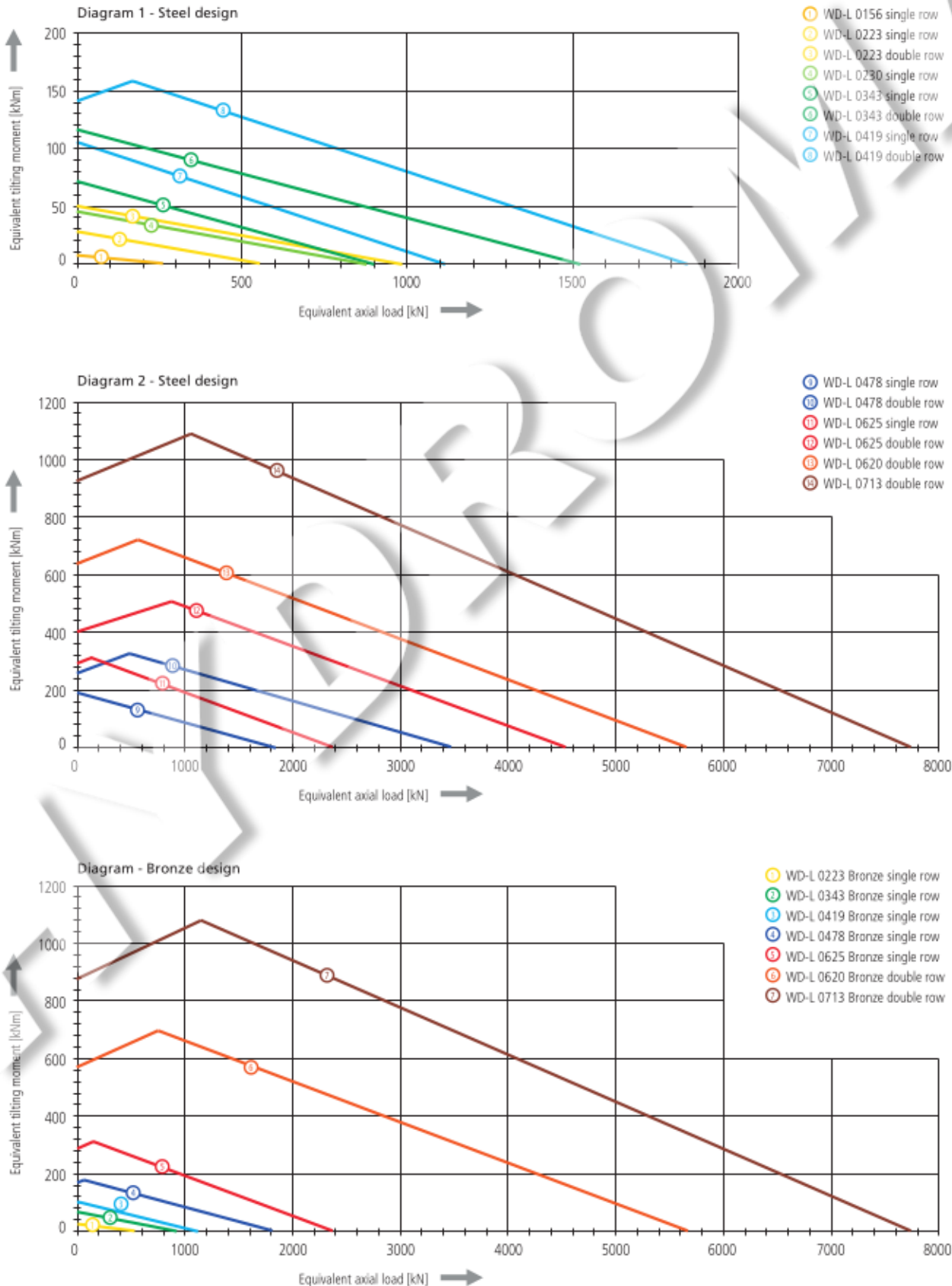

WD-L

WD-L series

Size WD-L 0419 / 1-row / 1 drive

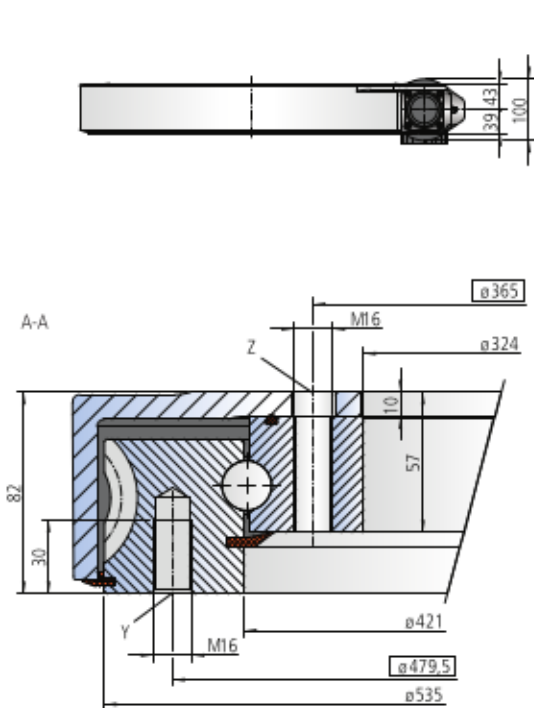

The mounting structure must support the housing to at least $\varnothing 419$ and at most to $\varnothing 544$

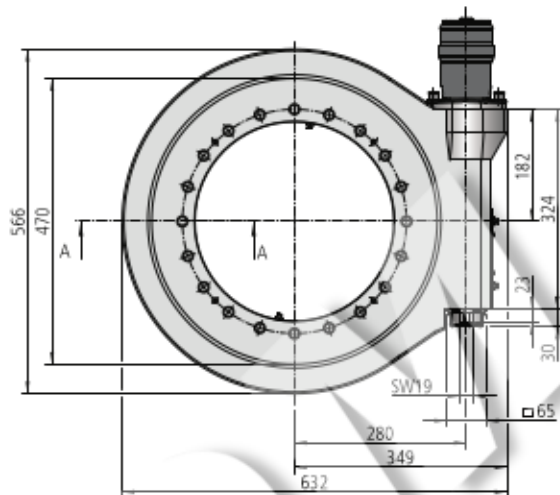

Mounting holes

Y = 20 drill holes M16-30 deep, evenly distributed
Z = 20 drill holes $\varnothing 18$ -10 deep / M16, evenly distributed

Lubricating ports

2 conical grease nipples on internal diameter
2 conical grease nipples on housing exterior
Slew drive supplied pre-lubricated

Drawing number WD-L 0419/3-04553			
Module	m	[mm]	5
Number of threads of the worm		[-]	1
Gear ratio	i	[-]	104
Self-locking gears		No**	
Max. torque $s_y = 1$	M_{d max}	[Nm]	15606
Nom. torque $s_{y0} = 1$ at $n = 1 \text{ min}^{-1}$	M_{d nom}	[Nm]	15606
Max. holding torque* $s_{y3} = 1$ (static)	M_{H max}	[Nm]	15606
Static load rating, radial	C_{o rad}	[kN]	413
Static load rating, axial	C_{o ax}	[kN]	1107
Dynamic load rating, radial	C_{rad}	[kN]	170
Dynamic load rating, axial	C_{ax}	[kN]	198
Weight, incl. 6 kg for hydraulic motor OMP (X) 160		[kg]	92

* Optionally with brake

** See: Technical Information, section Self-locking

The hydraulic/electric motor is selected according to the actual requirements and customer specification.

Selection example:

Performance data with hydraulic motor OMP (X) 160

Pressure differential	Δp	[bar]	140
Oil flow	Q	[l/min]	20
Output speed	n	[min ⁻¹]	1
Max. achievable torque	M_d	[Nm]	15606

Limiting load diagram for compressive loads

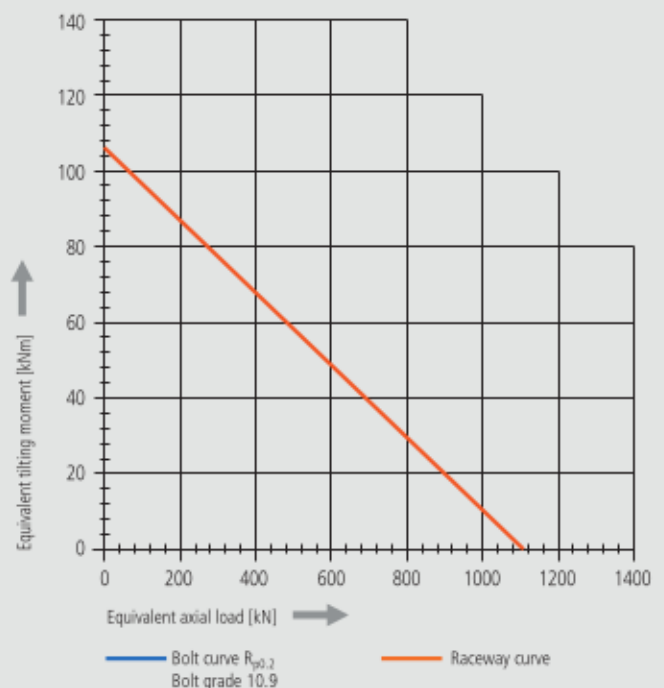

Please always observe the technical information!

Size WD-L 0419 / 1-row / 2 drives

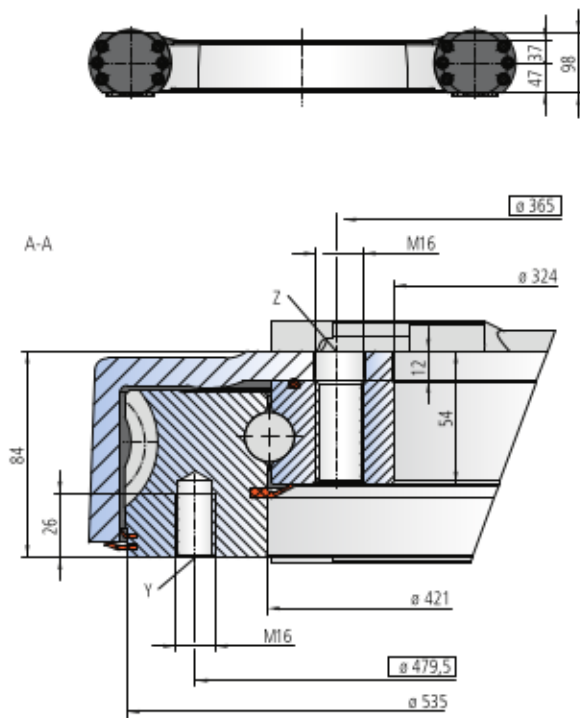

The mounting structure must support the housing to at least $\varnothing 419$ and at most to $\varnothing 486$

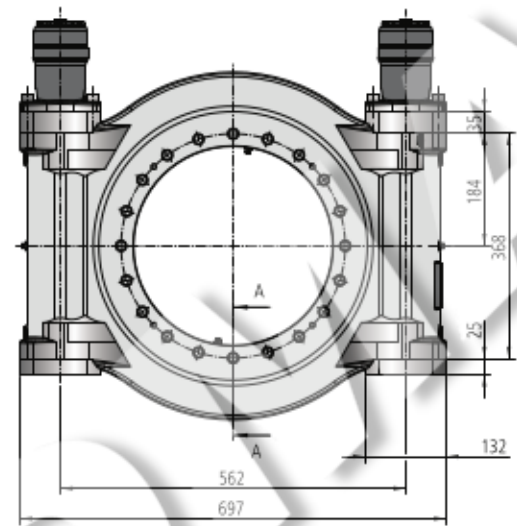

Mounting holes

- Y = 20 drill holes M16-30 deep, evenly distributed
- Z = 20 drill holes $\varnothing 18-12$ deep / M16, evenly distributed

Lubricating ports

- 2 conical grease nipples on internal diameter
- 2 conical grease nipples on housing exterior
- Slew drive supplied pre-lubricated

Drawing number WD-L 0419/3-10102

Module	m	[mm]	5
Number of threads of the worm		[-]	1
Gear ratio	i	[-]	104
Self-locking gears			No**
Max. torque $s_3 = 1$	M_{d max}	[Nm]	31212
Nom. torque $s_{30} = 1$ at $n = 1 \text{ min}^{-1}$	M_{d nom}	[Nm]	31212
Max. holding torque* $s_{35} = 1$ (static)	M_{h max}	[Nm]	44590
Static load rating, radial	C_{o rad}	[kN]	413
Static load rating, axial	C_{o ax}	[kN]	1107
Dynamic load rating, radial	C_{rad}	[kN]	170
Dynamic load rating, axial	C_{ax}	[kN]	198
Weight, incl. 12 kg for two hydraulic motors OMP (X) 160		[kg]	150

* Optionally with brake

** See: Technical Information, section Self-locking

The hydraulic/electric motor is selected according to the actual requirements and customer specification.

Selection example:

Performance data with two hydraulic motors OMP (X) 160

Pressure differential	Δp	[bar]	140
Oil flow	Q	[l/min]	40
Output speed	n	[min ⁻¹]	1
Max. achievable torque	M_d	[Nm]	31212

Limiting load diagram for compressive loads

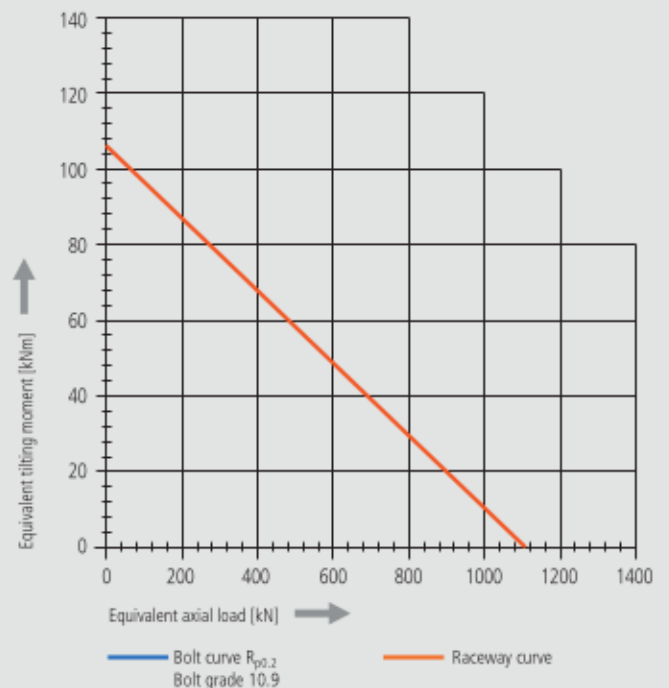

Please always observe the technical information!

WD-L series

Size WD-L 0419 / 2-row / 1 drive

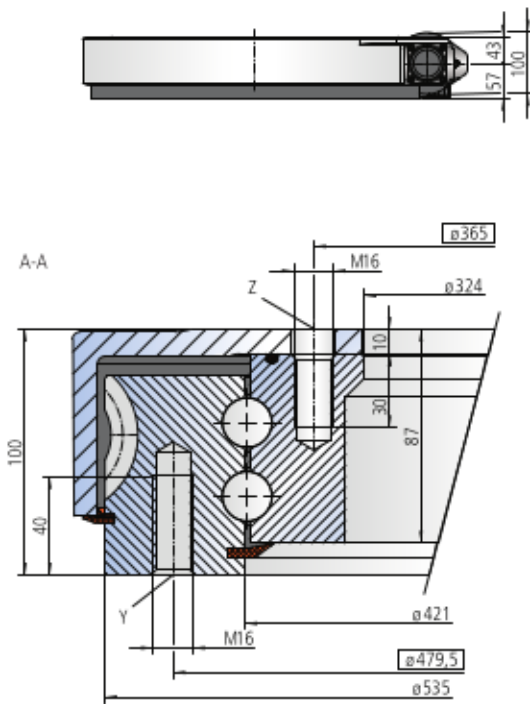

The mounting structure must support the housing to at least $\varnothing 419$ and at most to $\varnothing 544$

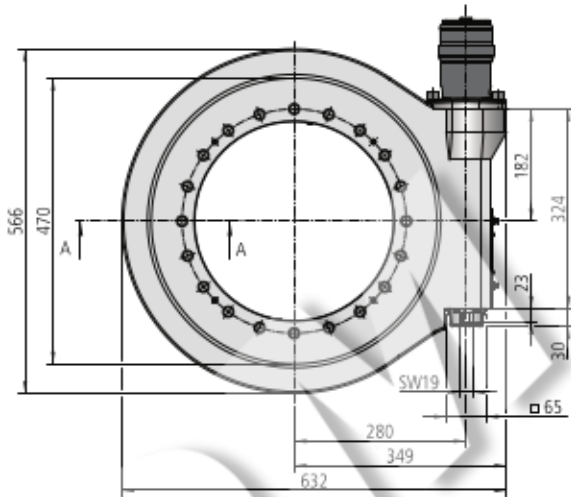

Mounting holes

Y = 20 drill holes M16-40 deep, evenly distributed
Z = 20 drill holes $\varnothing 18$ -10 deep / M16-30 deep, evenly distributed

Lubricating ports

4 conical grease nipples on internal diameter
2 conical grease nipples on housing exterior
Slew drive supplied pre-lubricated

Drawing number WD-L 0419/3-04684			
Module	m	[mm]	5
Number of threads of the worm		[-]	1
Gear ratio	i	[-]	104
Self-locking gears			No**
Max. torque $s_1 = 1$	M_{d max}	[Nm]	15606
Nom. torque $s_{0.2} = 1$ at $n = 1 \text{ min}^{-1}$	M_{d nom}	[Nm]	15606
Max. holding torque* $s_{0.2} = 1$ (static)	M_{h max}	[Nm]	15606
Static load rating, radial	C_{o rad}	[kN]	691
Static load rating, axial	C_{o ax}	[kN]	1849
Dynamic load rating, radial	C_{rad}	[kN]	277
Dynamic load rating, axial	C_{ax}	[kN]	323
Weight, incl. 6 kg for hydraulic motor OMP (X) 160		[kg]	112

* Optionally with brake

** See: Technical Information, section Self-locking

The hydraulic/electric motor is selected according to the actual requirements and customer specification.

Selection example:

Performance data with hydraulic motor OMP (X) 160

Pressure differential	Δp	[bar]	140
Oil flow	Q	[l/min]	20
Output speed	n	[min ⁻¹]	1
Max. achievable torque	M_d	[Nm]	15606

Limiting load diagram for compressive loads

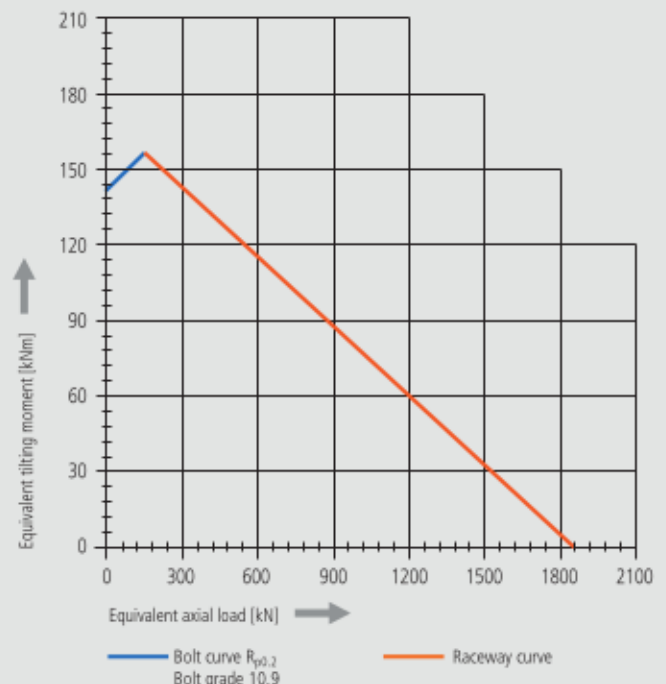

Please always observe the technical information!

Size WD-LC 0419 / 1-row / 1 drive - Bronze special design

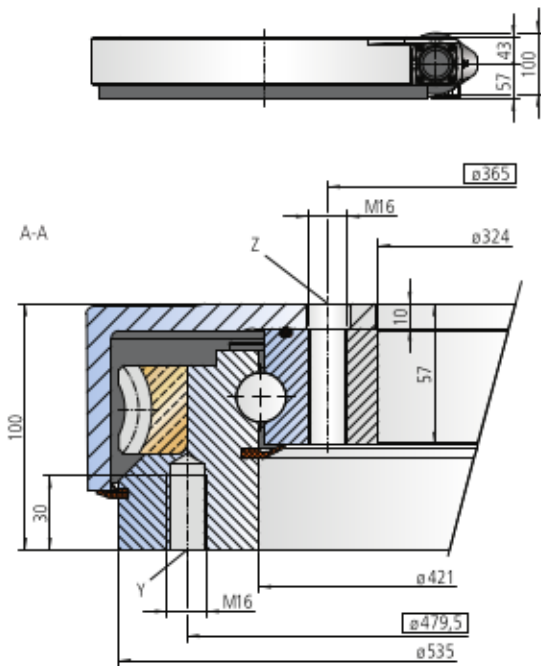

The mounting structure must support the housing to at least $\varnothing 419$ and at most to $\varnothing 544$

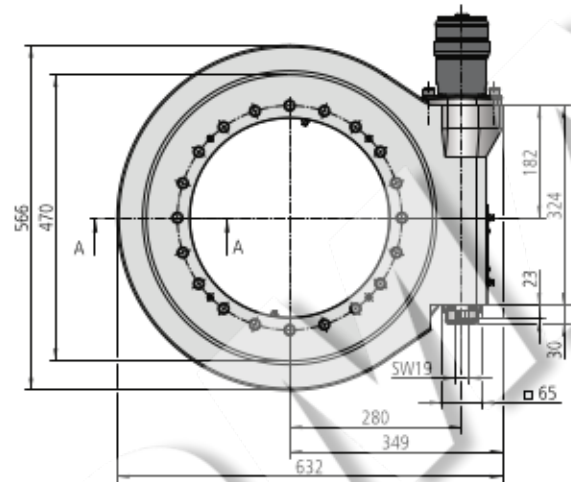

Mounting holes

- Y = 20 drill holes M16-30 deep, evenly distributed
- Z = 20 drill holes $\varnothing 18-10$ deep / M16, evenly distributed

Lubricating ports

- 2 conical grease nipples on internal diameter
- 2 conical grease nipples on housing exterior
- Slew drive supplied pre-lubricated

Drawing number WD-LC 0419/1-07861			
Module	m	[mm]	5
Number of threads of the worm		[-]	1
Gear ratio	i	[-]	104
Self-locking gears			No**
Max. torque $s_2 = 1$	M_{d max}	[Nm]	7166
Nom. torque $s_{20} = 1$ at $n = 1 \text{ min}^{-1}$	M_{d nom}	[Nm]	7166
Max. holding torque* $s_{25} = 1$ (static)	M_{h max}	[Nm]	7166
Static load rating, radial	C_{o rad}	[kN]	413
Static load rating, axial	C_{o ax}	[kN]	1107
Dynamic load rating, radial	C_{rad}	[kN]	170
Dynamic load rating, axial	C_{ax}	[kN]	198
Weight, incl. 6 kg for hydraulic motor OMP (X) 160		[kg]	103

* Optionally with brake

** See: Technical Information, section Self-locking

The hydraulic/electric motor is selected according to the actual requirements and customer specification.

Selection example:

Performance data with hydraulic motor OMP (X) 160

Pressure differential	Δp	[bar]	59
Oil flow	Q	[l/min]	17
Output speed	n	[min ⁻¹]	1
Max. achievable torque	M_d	[Nm]	7166

Limiting load diagram for compressive loads

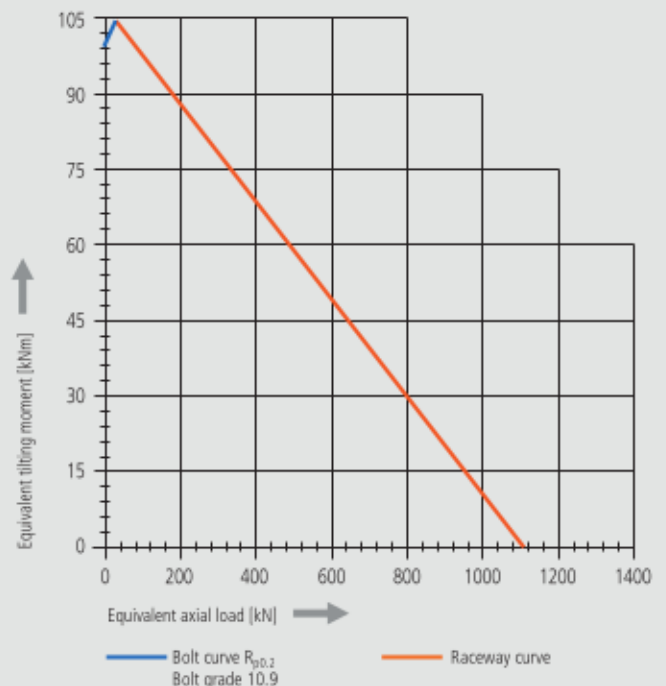

Please always observe the technical information!