

Part number:

**HYDROMA**

HYDRAULICKÉ SYSTÉMY

**HIDROMA**  
SISTEMS

UKLADY HYDRAULICZNE

**HYDROMA**

ГИДРАВЛИЧЕСКИЕ СИСТЕМЫ

# PVW3



| Nominal size |    |      |      | Max working pressure | Rated flow | Max flow rate | Min burst pressure |        |         | Fluid spillage |
|--------------|----|------|------|----------------------|------------|---------------|--------------------|--------|---------|----------------|
| DNP          | BG | ISO  | mm   |                      |            |               | Male               | Female | Coupled |                |
| 06           | 1  | 6.3  | 5    | 35                   | 12         | 17            | 140                | 140    | 140     | 0,8            |
| 10           | 2  | 10   | 8,5  | 32,5                 | 23         | 46            | 130                | 150    | 180     | 1,9            |
| 13           | 3  | 12.5 | 10,5 | 30                   | 45         | 90            | 120                | 150    | 140     | 2,7            |
| 20           | 4  | 19   | 15,7 | 25                   | 106        | 190           | 100                | 130    | 140     | 9,3            |
| 25           | 5  | 25   | 17,3 | 25                   | 189        | 280           | 100                | 130    | 140     | 16             |
| 30           | 6  | 31.5 | 29,6 | 25                   | 288        | 480           | 100                | 100    | 100     | 30             |

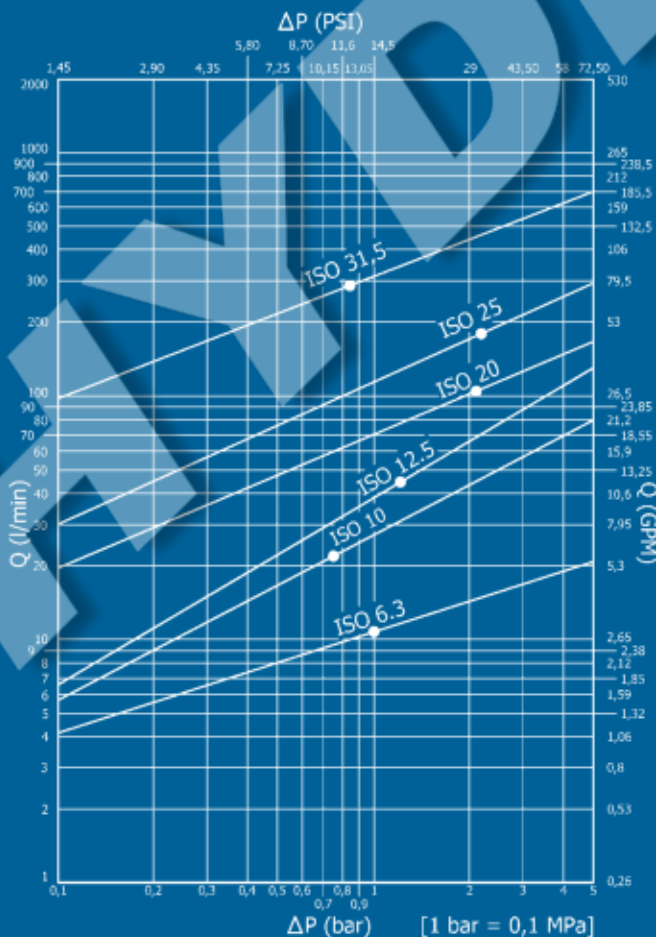

## Caratteristiche tecniche

- Intercambiabilità: con i principali produttori
- Occlusione: valvola
- Aggancio: a vite
- Materiale: acciaio
- Finitura: Zn-Fe (Cr III)
- Filettature: BSP – NPT – SAE – METRICHE
- Guarnizioni standard: NBR
- Temperatura d'esercizio: -25 °C +100 °C
- Guarnizioni opzionali: FKM, EPDM o altro
- Pressioni di esercizio: 250-350 bar
- Connessione in pressione: consentita (lato maschio o lato femmina)
- Massima pressione residua: pressione d'esercizio

## Technical data

- Interchange: with the main producers
- Occlusion: poppet
- Locking: screw
- Material: steel
- Finishing: Zn-Fe (Cr III)
- Threads: BSP – NPT – SAE – METRIC
- Standard seals: NBR
- Working temperature: -25 °C +100 °C
- Optional seals: FKM, EPDM or more
- Working pressure: 250-350 bar
- Connection under pressure: allowed (both male or female side)
- Max residual pressure: working pressure

## Technische Merkmale

- Austauschbarkeit: mit den wichtigsten Lieferanten
- Verschluss: ventil
- Kupplung: Schraubweise
- Werkstoff: Stahl
- Ausführung: Zn-Fe (Cr III)
- Gewinde: BSP – NPT – SAE – METRISCHE
- Standard-Dichtungen: NBR
- Betriebstemperatur: -25 °C +100 °C
- Dichtungen nach Wahl: FKM, EPDM, usw.
- Betriebsdruck: 250-350 bar
- Kuppeln unter Druck: erlaubt (Steckerseite oder Muffenseite)
- Max. Restdruck: Betriebsdruck

## Caracteristiques techniques

- Intercambiabilité: avec les principaux producteurs
- Obturation: clapet
- Accrochage: a vissé
- Matériel: acier
- Traitement: Zn-Fe (Cr III)
- Taraudage: BSP – NPT – SAE – METRIQUES
- Joints standard: NBR
- Température de service: -25 °C +100 °C
- Joints facultatifs: FKM, EPDM, ect.
- Pression de service: 250-350 bar
- Connexion sous pression: possible (côté male ou femelle)
- Pression restante max: pression de service

PV3 DN25 - BG 5 - ISO 25

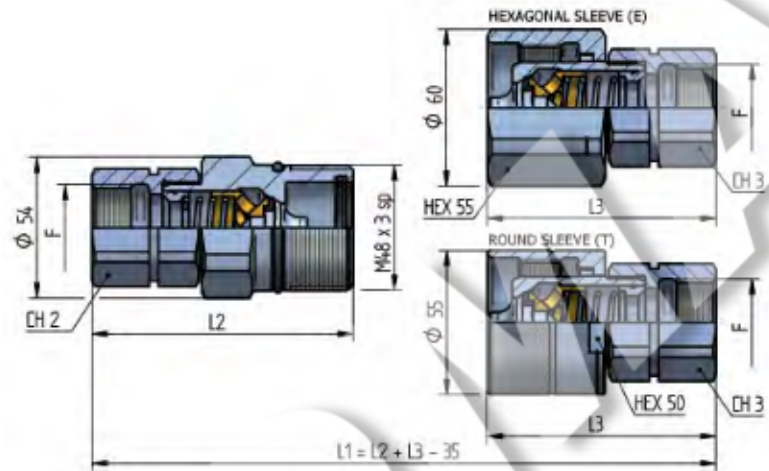

| THREADS | CH2 | L2  | CH3  | L3   | L4 | ØT         | F               | STANDARD     | FEMMINA - FEMALE - MUFFE - FEMELLE |                |                | MASCHIO - MALE - STECKER - MALE |            |              |
|---------|-----|-----|------|------|----|------------|-----------------|--------------|------------------------------------|----------------|----------------|---------------------------------|------------|--------------|
|         |     |     |      |      |    |            |                 |              | COD. F                             | Weight (g)     | Pack. (pcs.)   | COD. M                          | Weight (g) | Pack. (pcs.) |
| IG 1    | 41  | 100 | 41   | 87,5 | 18 |            | BSP 3/4"        | DIN 3852-2-X | PW3.2519.112                       | 837            | 10             | PW3.2519.113 T                  | 696        | 18           |
|         |     |     |      | 87,5 |    |            | DIN 3852-2-X    |              |                                    | PW3.2519.113 E | 776            | 18                              |            |              |
|         | 41  | 100 | 41   | 87,5 | 18 |            | NPT 3/4"        | ANSI B1.20.3 | PW3.2519.012                       | 844            | 10             | PW3.2519.013 T                  | 703        | 18           |
|         |     |     |      | 87,5 |    |            | ANSI B1.20.3    |              |                                    | PW3.2519.013 E | 783            | 18                              |            |              |
|         | 41  | 100 | 41   | 87,5 | 18 |            | BSP 1"          | DIN 3852-2-X | PW3.2525.112                       | 782            | 10             | PW3.2525.113 T                  | 641        | 18           |
|         |     |     |      | 87,5 |    |            | DIN 3852-2-X    |              |                                    | PW3.2525.113 E | 721            | 18                              |            |              |
|         | 41  | 100 | 41   | 87,5 | 18 |            | NPT 1"          | ANSI B1.20.3 | PW3.2525.012                       | 795            | 10             | PW3.2525.013 T                  | 654        | 18           |
|         |     |     |      | 87,5 |    |            | ANSI B1.20.3    |              |                                    | PW3.2525.013 E | 734            | 18                              |            |              |
| 41      | 100 | 41  | 87,5 | 18   |    | M30x1,5    | ISO 6149-1      | PW3.2530.102 | 810                                | 10             | PW3.2530.103 T | 669                             | 18         |              |
|         |     |     | 87,5 |      |    | ISO 6149-1 |                 |              | PW3.2530.103 E                     | 749            | 18             |                                 |            |              |
| IG 2    | 41  | 100 | 41   | 87,5 | 18 |            | 1"1/16-16 UN 2B | SAE J 1926-1 | PW3.2527.032                       | 831            | 10             | PW3.2527.033 T                  | 690        | 18           |
|         |     |     |      | 87,5 |    |            | SAE J 1926-1    |              |                                    | PW3.2527.033 E | 770            | 18                              |            |              |
|         | 41  | 100 | 41   | 87,5 | 18 |            | 1"5/16-12 UN 2B | SAE J 1926-1 | PW3.2533.032                       | 772            | 10             | PW3.2533.033 T                  | 631        | 18           |
|         |     |     |      | 87,5 |    |            | SAE J 1926-1    |              |                                    | PW3.2533.033 E | 711            | 18                              |            |              |
| AG 5    | 41  | 102 | 41   | 89,5 | 18 |            | BSP 1"          | DIN 3852-2-B | PW3.2525.212                       | 781            | 10             | PW3.2525.213 T                  | 641        | 18           |
|         |     |     |      | 89,5 |    |            | DIN 3852-2-B    |              |                                    | PW3.2525.213 E | 721            | 18                              |            |              |
|         | 41  | 100 | 41   | 87,5 | 16 |            | BSP 3/4"        | DIN 3852-2-A | PW3.2519.712                       | 755            | 10             | PW3.2519.713 T                  | 615        | 18           |
|         |     |     |      | 87,5 |    |            | DIN 3852-2-A    |              |                                    | PW3.2519.713 E | 695            | 18                              |            |              |
|         | 41  | 102 | 41   | 89,5 | 18 |            | BSP 1"          | DIN 3852-2-A | PW3.2525.712                       | 781            | 10             | PW3.2525.713 T                  | 641        | 18           |
|         |     |     |      | 89,5 |    |            | DIN 3852-2-A    |              |                                    | PW3.2525.713 E | 721            | 18                              |            |              |

THREADS



IG 1

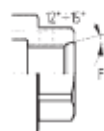

IG 2

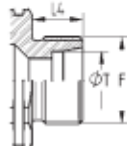

AG 3

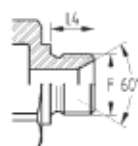

AG 5

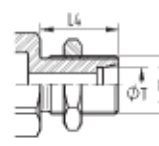

AGS 3